



LINEAR MOTION BEARINGS

Metric Dimensions

KHS

LM Series

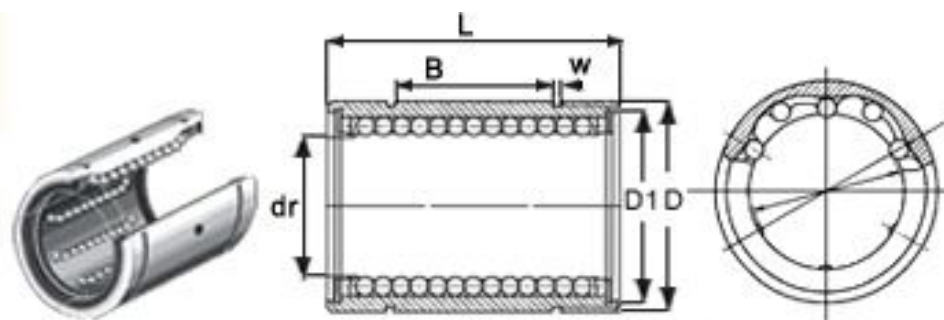

Dimension Table of LM Series

Designation	Weight (g)	Main dimensions and tolerance										Eccentricity μm	Radical Clearance (Max) μm	Basic Dynamic Load Rating C (Kgf)	Basic Static Load Rating CO (Kgf)
		dr mm	Tolerance μm	D mm	Tolerance μm	L mm	Tolerance μm	B mm	Tolerance μm	W mm	D1 mm				
LM 3	1.35	3		7		10		-		-	-			7	10.7
LM 4	1.9	4	0	8	0	12	0	-		-	-			9	13
LM 5	4	5	-8	10	-9	15	-120	10.2		1.1	9.6	8		17	21
LM 5UU	4	5		10		15		10.2		1.1	9.6			17	21
LM 6	7.6	6		12		19		13.5		1.1	11.5			21	27
LM 6UU	7.6	6		12		19		13.5		1.1	11.5	-3		21	27
LM 8S	10.4	8		15	0	17		11.5		1.1	14.3			18	22
LM 8SUU	10.4	8		15	-11	17		11.5		1.1	14.3			18	22
LM 8	15	8		15		24		17.5		1.1	14.3			28	40
LM 8UU	15	8	3	15		24		17.5		1.1	14.3			28	40
LM 10	29.5	10	-9	19		29	0	22	-200	1.3	18	12		38	56
LM 10UU	29.5	10		19		29	-200	22		1.3	18			38	56
LM 12	31.5	12		21	3	30		23		1.3	20			42	61
LM 12UU	31.5	12		21	-13	30		23		1.3	20	-4		42	61
LM 13	43	13		23		32		23		1.3	22			52	80
LM 13UU	43	13		23		32		23		1.3	22			52	80
LM 16	69	16		28		37		28.5		1.6	27			79	120
LM 16UU	69	16		28		37		28.5		1.6	27			79	120
LM 20	87	20		32		42		30.5		1.6	30.5			90	140
LM 20UU	87	20	0	32	0	42		30.5		1.6	30.5	-6		90	140
LM 25	220	25	-10	40	-16	59		41		1.85	38			100	160
LM 25UU	220	25		40		59		41		1.85	38	15		100	160
LM 30	250	30		45		64		44.5		1.85	43			160	280
LM 30UU	250	30		45		64		44.5		1.85	43			160	280
LM 35	390	35		52		70		49.5		2.1	49			170	320
LM 35UU	390	35		52		70		49.5		2.1	49	-8		170	320
LM 40	585	40		60		80		60.5		2.1	57			220	410

LM



LINEAR MOTION BEARINGS

Metric Dimensions

LM Series

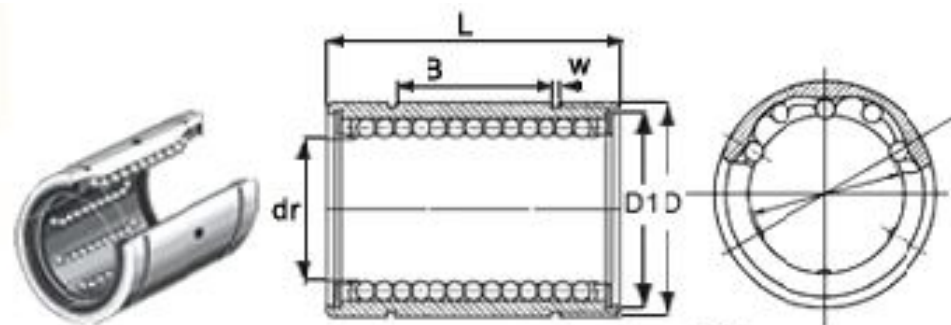

Dimension Table of LM Series

Designation	Weight (g)	Main dimensions and tolerance										Eccentricity μm	Radical Clearance (Max) μm	Basic Dynamic Load Rating C (Kgf)	Basic Static Load Rating CO (Kgf)
		mm	dr Tolerance μm	D mm	Tolerance μm	L mm	Tolerance μm	B mm	Tolerance μm	W mm	D1 mm				
LM 40UU	585	40	0	80	0	80	0	80.5	0	2.1	57	20	-10	220	410
LM 50	1,580	50	-12	80	-19	100	-300	74	-300	2.6	78.5		390	810	
LM 50UU	1,580	50		80		100		74		2.6	78.5	25	-13	390	810
LM 60	1,880	60		90		110	0	85	0	3.15	88.5		480	1020	
LM 60UU	1,880	60	0	90	0	110	-300	85	-300	3.15	88.5	480	1020		
LM 80	4,420	80	-15	120	-22	140	0	105.5	0	4.15	118	25	-20	750	1830
LM 80UU	4,420	80		120		140	-400	105.5	-400	4.15	118		750	1830	

